





GANCHO COLGADOR CG1



	Código	8431488	Medida	Acabado				€uros
Caja	39511	395111	70x15 mm	ZN	-	50	500	

Incluye tornillo regulador

Acero



ZINCADO

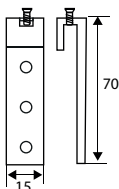

PLACA COLGADOR CG2



	Código	8431488	Medida	Acabado				€uros
Caja	39501	395012	50x50 mm	ZN	-	50	500	

Acero



ZINCADO

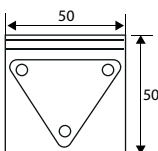

JGO GANCHO COLGADOR CG1 + PLACA CG2

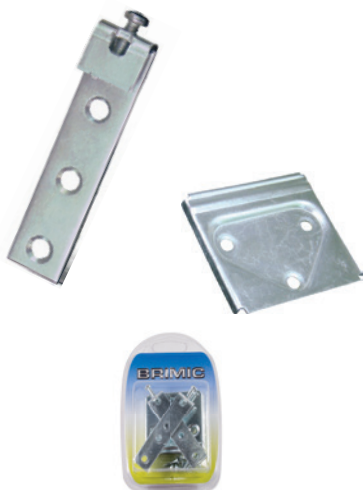

	Código	8431488	Tipo	Acabado				€uros
Caja	00206	002064	gancho+placa	ZN	-	50	250	
Blister	90316	903163	gancho+placa	ZN	2+2	-	10	

Incluye tornillos en el blister

Acero



ZINCADO

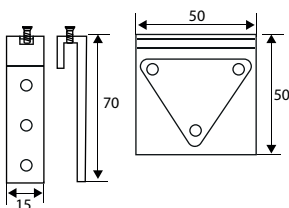

COLGADOR ESCUADRA CG3

	Código	8431488	Medida/Mano	Acabado				€uros
Caja	39521	395210	72 mm / Dcha	ZN	-	50	500	
	39522	395227	72 mm / Izda	ZN	-	50	500	

Acero

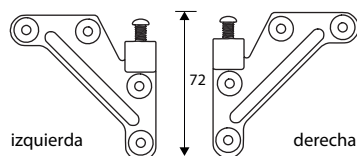

JGO COLGADOR ESCUADRA CG3 + PLACA CG2

	Código	8431488	Medida	Acabado				€uros
Blister	90315	903156	72x72 mm	ZN	1 izda +1 dcha +2	-	10	

Acero

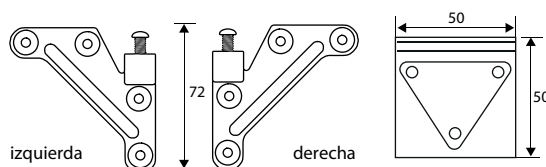

Incluye tornillos en el blister



COLGADOR BIVALENTE CG4

	Código	8431488	Medida	Acabado				€uros
Caja	39541	395418	59x49 mm	BL	-	25	250	
	39542	395425	59x49 mm	BE	-	25	250	

Acero y ABS

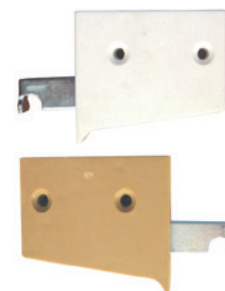
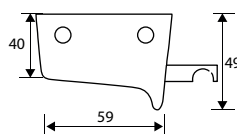

JGO COLGADOR BIVALENTE CG4 + PLACA CG2

	Código	8431488	Medida	Acabado				€uros
Blister	90317	903170	59x49 mm	BL	2+2	-	10	
	90318	903187	59x49 mm	BE	2+2	-	10	

Acero y ABS

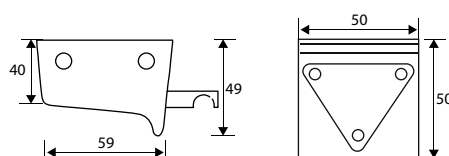

Incluye tornillos en el blister



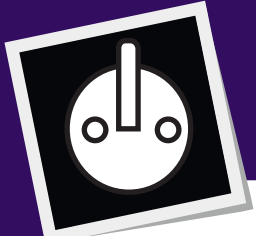

JGO COLGADOR COCINA OCULTO CG5



	Código	8431488	Medida	Acabado				€uros
Caja	39561	395616	160x56 mm	ZN	-	50	-	
Blister	92428	924281	160x56 mm	ZN	1	-	10	

Carga máxima útil por colgador 65 Kgs
 Ajustable en altura 18 mm
 Regulable en profundidad 9 mm

Acero

ZINCADO

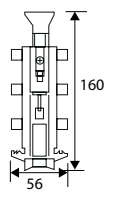

PLACA COLGADOR TIRA CG20



	Código	8431488	Medida	Acabado				€uros
Caja	39552	395524	2 mts	ZN	-	10	-	

Acero

ZINCADO

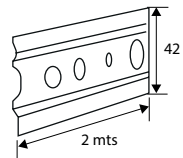

PLACA COLGADOR DOBLE CG21



	Código	8431488	Medida	Acabado				€uros
Caja	39551	395517	130x30 mm	ZN	-	100	500	

Acero

ZINCADO

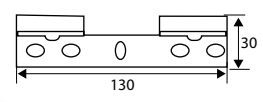

COLGADOR ESCUADRA REGULABLE CG6



	Código	8431488	Medida	Acabado				€uros
Caja	39531	395319	51x48 mm	ZN	-	50	250	

Acero

ZINCADO

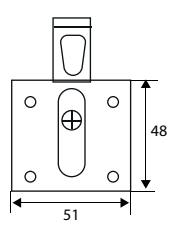

COLGADOR ESCUADRA TRIÁNGULO CG7

	Código	8431488	Medida	Acabado				€uros
Caja	39500	395005	70x70 mm	ZN	-	100	500	
Blister	90838	908380	70x70 mm	ZN	2	-	10	

Acero



ZINCADO

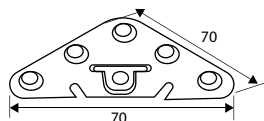

COLGADOR MUEBLE REVERSIBLE CG8

	Código	8431488	Medida	Acabado				€uros
Caja	30881	308814	45x35 mm	ZN	-	100	1000	
Blister	91700	917009	45x35 mm	ZN	4	-	10	

Acero



ZINCADO



Incluye tornillos en el blister
Espesor 1,5 mm

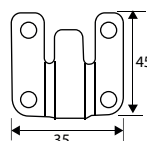

COLGADOR MUEBLE CG9

	Código	8431488	Medida	Acabado				€uros
Caja	30850	308500	50x15 mm	ZN	-	100	1000	
	30880	308807	80x15 mm	ZN	-	100	1000	
Blister	90524	905242	50x15 mm	ZN	4	-	10	
	90525	905259	80x15 mm	ZN	4	-	10	

Acero



ZINCADO

Incluye tornillos en el blister

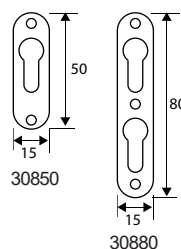

COLGADOR MUEBLE CG10

	Código	8431488	Medida	Acabado				€uros
Caja	30851	308517	48x13 mm	ZN	-	100	1000	
Blister	91121	911212	48x13 mm	ZN	4	-	10	

Acero



ZINCADO

Incluye tornillos en el blister

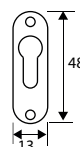



COLGADOR MUEBLE EMBUTIR CG22



	Código	8431488	Medida	Acabado				€uros
Caja	30858	308586	30 mm	ZN	-	25	250	
Blisters	92333	923338	30 mm	ZN	2	-	10	

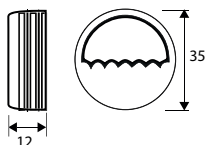

Zamak



ZINCADO

PLACA COLGADOR GALERÍA CG11



	Código	8431488	Medida Ax B	Acabado				€uros
Caja	30940	309408	40x18 mm	ZN	-	200	2000	
	30950	309507	50x18 mm	ZN	-	200	2000	
	30960	309606	60x18 mm	ZN	-	200	2000	
	30970	309705	70x20 mm	ZN	-	200	1000	
	30980	309804	80x20 mm	ZN	-	200	1000	
Blisters	90526	905266	40x18 mm	ZN	4	-	10	
	90527	905273	50x18 mm	ZN	4	-	10	
	90528	905280	60x18 mm	ZN	4	-	10	
	90529	905297	70x20 mm	ZN	4	-	10	
	90530	905303	80x20 mm	ZN	4	-	10	

Incluye tornillos en el blister

Acero



ZINCADO

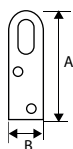

PLACA COLGADOR EXTINTOR CG14/CG15

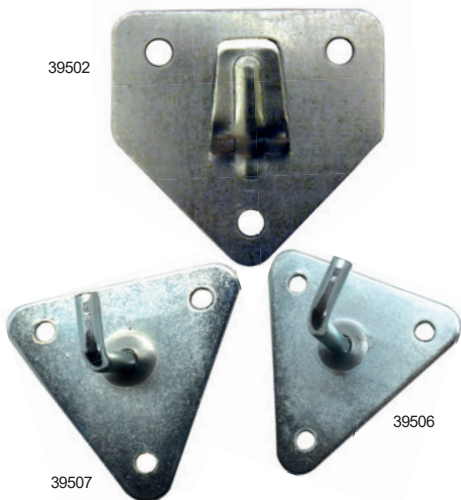

	Código	8431488	Kgs	Tipo	Acabado				€uros
Caja	39502	395029	6 Kgs	polvo1	ZN	-	25	125	
	39506	395067	2 Kgs	CO2	ZN	-	25	125	
	39507	395074	5 Kgs	CO2	ZN	-	25	125	
Blisters	91242	912424	6 Kgs	polvo1	ZN	1	-	10	

Acero



ZINCADO

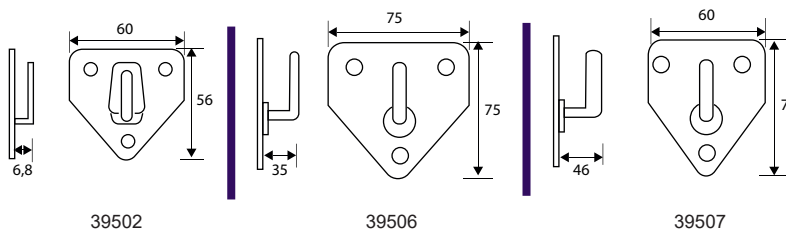

COLGADOR CUADROS DENTADO CG19

	Código	8431488	Medida	Acabado				€uros
Caja	32006	320069	32x8 mm	LTD	-	100	1000	
Blister	91886	918860	32x8 mm	LTD	4	-	10	

Acero

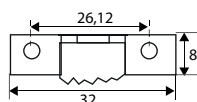

COLGADOR CUADROS TELA ENGOMADA CG18

	Código	8431488	Medida	Acabado				€uros
Caja	32003	320038	30 mm	BL	-	200	2000	
Blister	90885	908854	30 mm	BL	8	-	10	

Goma



GANCHO "X" CG13

	Código	8431488	Modelo	Acabado				€uros
Caja	32100	321004	Nº 0	LTD	-	100	1000	
	32101	321011	Nº 1	LTD	-	100	1000	
	32102	321028	Nº 2	LTD	-	100	1000	
Blister	90456	904566	Nº 0	LTD	10	-	10	
	90457	904573	Nº 1	LTD	10	-	10	
	90458	904580	Nº 2	LTD	10	-	10	

Acero



Presentación: caja de 10 uds con puntas

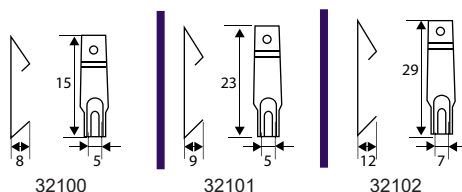

COLGADOR CUADROS CG12

	Código	8431488	Modelo	Acabado				€uros
Caja	32000	320007	Nº 0	LTD	-	100	2500	
	32001	320014	Nº 1	LTD	-	100	2500	
	32002	320021	Nº 2	LTD	-	100	2500	
Blister	90459	904597	Nº 0	LTD	10	-	10	
	90460	904603	Nº 1	LTD	10	-	10	
	90461	904610	Nº 2	LTD	10	-	10	

Acero



Incluye puntas en el blíster

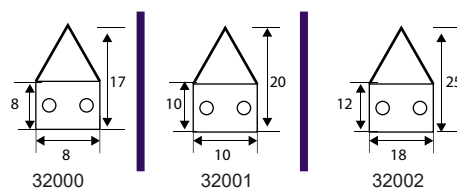

Te sugiero:

PUNTAS DE LATÓN
Pág. 189





COLGADOR CUADROS CG16

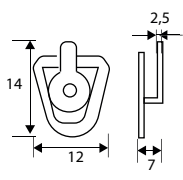

	Código	8431488	Tipo	Acabado				€uros
Blister	90872	908724	pequeño	BL	12	-	10	

Plástico



BLANCO

COLGADOR CUADROS CG17

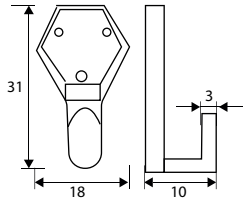

	Código	8431488	Tipo	Acabado				€uros
Blister	90873	908731	grande	BL	4	-	10	

Plástico



BLANCO

GANCHO FORMA "S" CG23



código	A	B	C
50325	25 mm	2,2 mm	5 mm
50330	30 mm	2,7 mm	6 mm
50335	35 mm	3,5 mm	7 mm
50340	40 mm	4,0 mm	9 mm
50350	50 mm	4,5 mm	9 mm
50360	60 mm	5,0 mm	8 mm
50370	70 mm	6,0 mm	8 mm
50380	80 mm	6,0 mm	9 mm

	Código	8431488	Medida A	Acabado				€uros
Caja	50325	503257	25 mm	ZN	-	100	2500	
	50330	503301	30 mm	ZN	-	100	2500	
	50335	503356	35 mm	ZN	-	100	2500	
	50340	503400	40 mm	ZN	-	100	1000	
	50350	503509	50 mm	ZN	-	100	500	
	50360	503608	60 mm	ZN	-	100	500	
	50370	503707	70 mm	ZN	-	100	300	
	50380	503806	80 mm	ZN	-	100	300	
Blister	90464	904641	25 mm	ZN	8	-	10	
	90465	904658	30 mm	ZN	6	-	10	
	90466	904665	35 mm	ZN	6	-	10	
	90467	904672	40 mm	ZN	6	-	10	
	90468	904689	50 mm	ZN	4	-	10	
	90469	904696	60 mm	ZN	4	-	10	
	90470	904702	70 mm	ZN	2	-	10	
	90471	904719	80 mm	ZN	2	-	10	

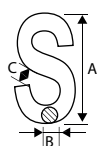

Acero



ZINCADO

PLACA AMARRE REDONDA AP8

	Código	8431488	Medida A	Acabado				€uros
Caja	80062	800622	33 mm	INOX	-	5	125	
	80063	800639	40 mm	INOX	-	5	125	
	80064	800646	50 mm	INOX	-	5	50	
Blister	92354	923543	33 mm	INOX	2	-	10	
	92355	923550	40 mm	INOX	2	-	10	
	92356	923567	50 mm	INOX	2	-	10	

Acero Inoxidable AISI 316

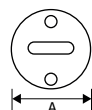

PLACA AMARRE REDONDA C/ANILLA AP9

	Código	8431488	Medida A	Acabado				€uros
Caja	80065	800653	33 mm	INOX	-	5	125	
	80066	800660	40 mm	INOX	-	5	125	
	80067	800677	50 mm	INOX	-	5	50	
Blister	92357	923574	33 mm	INOX	2	-	10	
	92358	923581	40 mm	INOX	2	-	10	
	92359	923598	50 mm	INOX	2	-	10	

Acero Inoxidable AISI 316

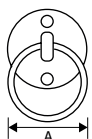

PLACA AMARRE OVAL AP10

	Código	8431488	Medida AxB	Acabado				€uros
Caja	80068	800684	45x17 mm	INOX	-	5	125	
	80069	800691	60x20 mm	INOX	-	5	125	
	80070	800707	80x26 mm	INOX	-	5	50	
Blister	92360	923604	45x17 mm	INOX	2	-	10	
	92361	923611	60x20 mm	INOX	2	-	10	
	92362	923628	80x26 mm	INOX	2	-	10	

Acero Inoxidable AISI 316

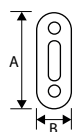

PLACA AMARRE OVAL C/ANILLA AP11

	Código	8431488	Medida AxB	Acabado				€uros
Caja	80071	800714	45x17 mm	INOX	-	5	125	
	80072	800721	60x20 mm	INOX	-	5	125	
	80073	800738	80x26 mm	INOX	-	5	50	
Blister	92363	923635	45x17 mm	INOX	2	-	10	
	92364	923642	60x20 mm	INOX	2	-	10	
	92365	923659	80x26 mm	INOX	2	-	10	

Acero Inoxidable AISI 316

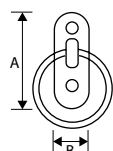



ANILLA SOLDADA C/HEMRILLA AP4



	Código	8431488	Medida	Acabado				€uros
Caja	80052	800523	65x50x9 mm	ZN	-	10	100	
	80053	800530	65x50x9 mm	NE	-	10	100	
Blister	92139	921396	65x50x9 mm	ZN	2	-	10	
	92165	921655	65x50x9 mm	NE	2	-	10	

Grosor anilla: 7 mm

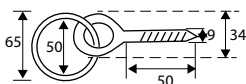

Acero
 ZINCADO NEGRO

GANCHO C/PLACA MÓVIL AP5



	Código	8431488	Medida	Acabado				€uros
Caja	80058	800585	70x45x7,5 mm	ZN	-	10	100	
	80059	800592	70x45x7,5 mm	NE	-	10	100	
Blister	92142	921426	70x45x7,5 mm	ZN	2	-	10	
	92168	921686	70x45x7,5 mm	NE	2	-	10	

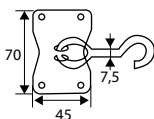

Acero
 ZINCADO NEGRO

ANILLA SOLDADA C/PLACA AP6



	Código	8431488	Medida	Acabado				€uros
Caja	80054	800547	70x45x50 mm	ZN	-	10	100	
	80055	800554	70x45x50 mm	NE	-	10	100	
Blister	92140	921402	70x45x50 mm	ZN	2	-	10	
	92166	921662	70x45x50 mm	NE	2	-	10	

Grosor anilla: 7 mm

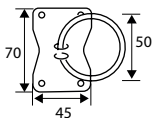

Acero
 ZINCADO NEGRO

GANCHO C/PLACA FIJO AP7



	Código	8431488	Medida	Acabado				€uros
Caja	80056	800561	45x45x55 mm	ZN	-	10	100	
	80057	800578	45x45x55 mm	NE	-	10	100	
Blister	92141	921419	45x45x55 mm	ZN	2	-	10	
	92167	921679	45x45x55 mm	NE	2	-	10	

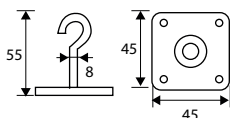

Acero
 ZINCADO NEGRO

ANILLA PLACA P/TOLDOS AP3

	Código	8431488	Medida	Acabado				€uros
Caja	80060	800608	45x25x5 mm	ZN	-	10	500	
	80061	800615	45x25x5 mm	INOX	-	10	250	
Blister	92131	921310	45x25x5 mm	ZN	2	-	10	
	92132	921327	45x25x5 mm	INOX	2	-	10	

ZN: Acero

INOX: Acero Inoxidable AISI 316



ZINCADO INOX

Incluye tornillos en el blister

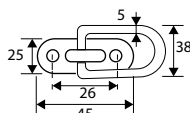

SOPORTE HAMACA ABIERTO AP1

	Código	8431488	Medida	Acabado				€uros
	80044	800448	100x100x5 mm	ZN	-	1	2	
	80045	800455	100x100x5 mm	BL	-	1	2	
	80050	800509	100x100x5 mm	NE	-	1	2	

Acero



ZINCADO BLANCO NEGRO

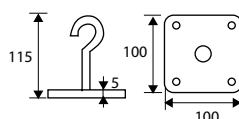

SOPORTE HAMACA CERRADO AP2

	Código	8431488	Medida	Acabado				€uros
	80046	800462	100x100x5 mm	ZN	-	1	2	
	80047	800479	100x100x5 mm	BL	-	1	2	
	80051	800516	100x100x5 mm	NE	-	1	2	

Acero



ZINCADO BLANCO NEGRO

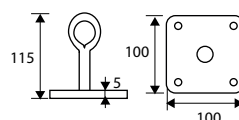

Te sugiero:

PLACA C/TUERCA
Pág. 317



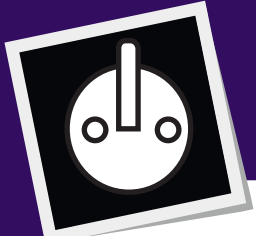

HEMBRILLA C/TUERCA ABIERTA HM2



	Código	8431488	Medida Ax B	Acabado				€uros
Caja	80037	800370	M3x30 mm	ZN	-	100	3000	
	80038	800387	M4x30 mm	ZN	-	100	1000	
	80039	800394	M5x35 mm	ZN	-	100	1000	
	80040	800400	M6x50 mm	ZN	-	100	800	
	80041	800417	M8x60 mm	ZN	-	50	400	
	80042	800424	M10x70 mm	ZN	-	20	160	
	80043	800431	M12x80 mm	ZN	-	20	100	
	80080	800806	M3x30 mm	INOX	-	25	625	
	80081	800813	M4x40 mm	INOX	-	25	625	
	80082	800820	M5x50 mm	INOX	-	25	625	
Blister	91248	912486	M3x30 mm	ZN	4	-	10	
	91249	912493	M4x30 mm	ZN	4	-	10	
	91250	912509	M5x35 mm	ZN	4	-	10	
	91251	912516	M6x50 mm	ZN	2	-	10	
	91252	912523	M8x60 mm	ZN	2	-	10	

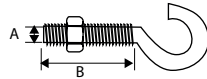

ZN: Acero
INOX: Acero Inoxidable

ZINCADO INOX

HEMBRILLA C/TUERCA SOLDADA HM1



	Código	8431488	Medida Ax B	Acabado				€uros
Caja	80030	800301	M3x30 mm	ZN	-	100	3600	
	80031	800318	M4x30 mm	ZN	-	100	2400	
	80032	800325	M5x40 mm	ZN	-	100	1600	
	80033	800332	M6x50 mm	ZN	-	100	800	
	80048	800486	M6x100 mm	ZN	-	100	400	
	80034	800349	M8x60 mm	ZN	-	50	400	
	80049	800493	M8x100 mm	ZN	-	50	200	
	80035	800356	M10x70 mm	ZN	-	20	160	
	80036	800363	M12x80 mm	ZN	-	20	80	
	80074	800745	M3x30 mm	INOX	-	25	625	
	80075	800752	M4x40 mm	INOX	-	25	625	
	80076	800769	M5x50 mm	INOX	-	25	625	
	80077	800776	M6x60 mm	INOX	-	25	250	
	80078	800783	M8x80 mm	INOX	-	25	250	
	80079	800790	M10x100 mm	INOX	-	10	100	
Blister	91243	912431	M3x30 mm	ZN	4	-	10	
	91244	912448	M4x30 mm	ZN	4	-	10	
	91245	912455	M5x40 mm	ZN	4	-	10	
	91246	912462	M6x50 mm	ZN	2	-	10	
	91247	912479	M8x60 mm	ZN	2	-	10	

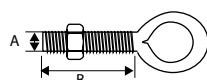

ZN: Acero
INOX: Acero Inoxidable

ZINCADO INOX

ALZAPAÑO TORNEADO PER19

	Código	8431488	Medida A	Acabado				€uros
Caja	50225	502250	25 mm	LT	-	100	500	
Blister	90463	904634	25 mm	LT	2	-	10	

Latón



LATÓN

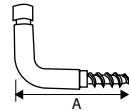

PERCHA EMBUTIR PER9

	Código	8431488	Medida	Acabado				€uros
Caja	28026	280264	80x20 mm	NS	-	4	100	

Zamak



NÍQUEL SATINADO

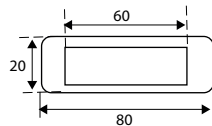

PERCHA EMBUTIR PER10

	Código	8431488	Medida	Acabado				€uros
Caja	28027	280271	140x16 mm	NS	-	4	96	

Zamak



NÍQUEL SATINADO

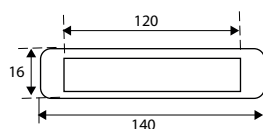



PERCHA RÚSTICA PER16



	Código	8431488	Medida	Acabado				€uros
Caja	28001	280011	108x75 mm	LE	-	4	20	
	28003	280035	108x75 mm	PE	-	4	20	
	28004	280042	108x75 mm	LP	-	4	20	

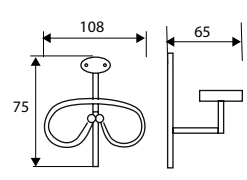

Zamak

LATÓN ENVEJECIDO
 PLATA ENVEJECIDA
 LATÓN PULIDO

PERCHA FORJA PER5



	Código	8431488	Medida	Acabado				€uros
Caja	28015	280158	70x70 mm	NE	-	4	40	

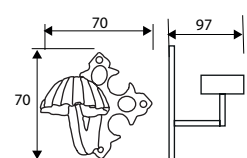

Zamak

NEGRO

PERCHA FORJA PER6



	Código	8431488	Medida	Acabado				€uros
Caja	28016	280165	70x70 mm	NE	-	4	40	

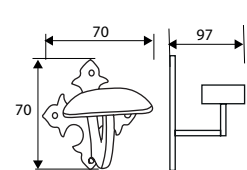

Zamak

NEGRO

PERCHA RÚSTICA PER17

	Código	8431488	Medida	Acabado				€uros
Caja	28011	280110	205x75 mm	LE	-	4	20	
	28013	280134	205x75 mm	PE	-	4	20	
	28014	280141	205x75 mm	LP	-	4	20	

Zamak

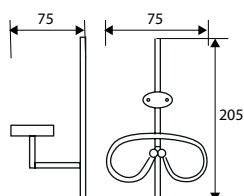

PERCHA FORJA PER7

	Código	8431488	Medida	Acabado				€uros
Caja	28017	280172	120X85 mm	NE	-	4	20	

Zamak

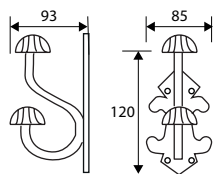

PERCHA FORJA PER8

	Código	8431488	Medida	Acabado				€uros
Caja	28018	280189	120X85 mm	NE	-	4	20	

Zamak

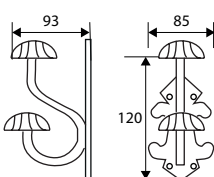



PERCHA SIMPLE PER12



	Código	8431488	Medida	Acabado				€uros
Caja	28030	280301	60x20 mm	INOX	-	4	100	
	28029	280295	79x20 mm	INOX	-	4	100	

Acero Inoxidable

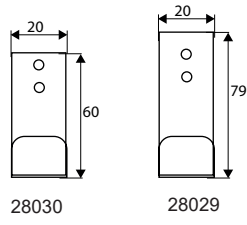

PERCHA DOBLE PER14



	Código	8431488	Medida	Acabado				€uros
Caja	28031	280318	90x20 mm	INOX	-	4	100	

Acero Inoxidable

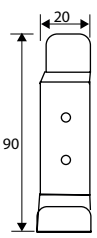

PERCHA DOBLE PER2



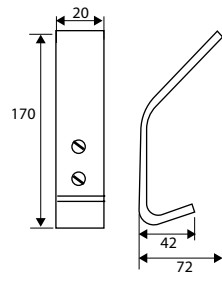

	Código	8431488	Medida	Acabado				€uros
Caja	28024	280240	170x42 mm	INOX	-	4	20	

Acero Inoxidable



PERCHA CUADRADA PER11

	Código	8431488	Medida	Acabado				€uros
Caja	28028	280288	35x35 mm	INOX	-	4	100	



Acero Inoxidable

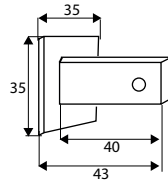

INOX



PERCHA REDONDA PER1

	Código	8431488	Medida	Acabado				€uros
Caja	28023	280233	32x50 mm	INOX	-	4	100	



Acero Inoxidable

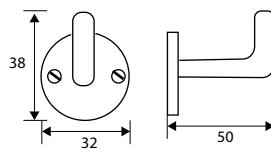

INOX



PERCHA 2 GANCHOS PER15

	Código	8431488	Medida	Acabado				€uros
Caja	28032	280325	185x72 mm	INOX	-	4	12	

Acero Inoxidable



INOX

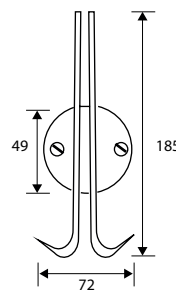



PERCHA PROBADOR PER3



	Código	8431488	Medida	Acabado				€uros
Caja	28025	280257	55x20 mm	INOX	-	4	100	

Acero Inoxidable

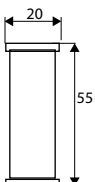

PERCHA TREBOL PER4

	Código	8431488	Medida	Acabado				€uros
Caja	28008	280080	80x65 mm	LTD	-	25	125	
	28009	280097	80x65 mm	ZN	-	25	125	
	28010	280103	80x65 mm	BL	-	25	125	

Zamak

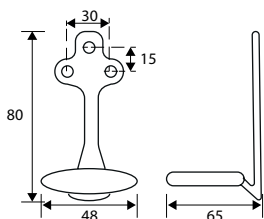





Te sugiero:

PERCHA C/TOPE GOMA PER18
Pág. 154

